



叠美（上海）灯饰有限公司

地址：广东省中山市古镇海洲东岸北路213号   |   邮编：528421  
电话：0760-89832929   |   传真：0760-22361236  
http:// www.dimids.com   |   E-mail：307147102@qq.com

DM SHANGHAI LIGHTING CO.,LTD

地址：广东省中山市古镇海洲东岸北路213号   |   邮编：528421  
电话：0760-89832929   |   传真：0760-22361236  
http:// www.dimids.com   |   E-mail：307147102@qq.com



微信公众号



灯具商城



艺术品商城





DM LIGHTING

叠 | 美 | 灯 | 饰

TRADITION

& MODERNITY  
moments





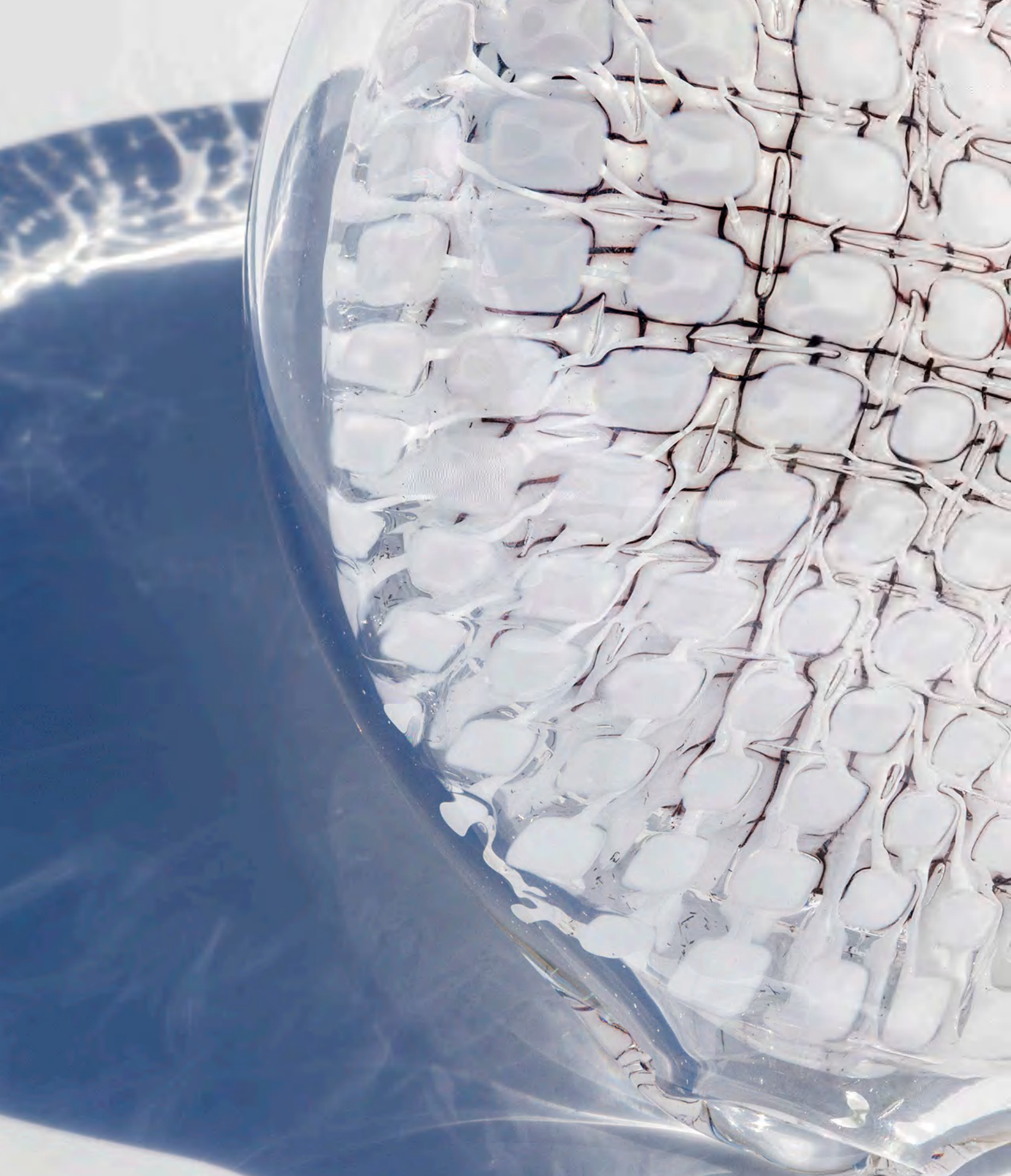

## INTRODUCTION

"Dimi" was founded in 2005, has completed a number of international five-star hotel decoration. Has 10 years of lighting and design manufacturing experience, exquisite technology, let us in engineering to achieve a lot of bold ideas. Every idea is a bottleneck breakthrough, by experienced master carefully completed. Ingenuity spirit, the simple things to the extreme. Do one thing with your heart, This kind of love from the heart, from the soul of the true, just a simple thing to the extreme.

It continues the spirit of craftsmanship, after a long time of accumulation and precipitation, has now infiltrated the enterprise to every inch the soil, including this soil to everyone's heart. Every craftsman's elaboration makes the product from beautiful to high quality. They have their own craft temperature in the product, forming a fold under the shape of the Dimi products can not be copied the verve and dignity Temperament.

Dimi's passion for lighting and continuous pursuit of innovation have made us a unique position in today's lighting market.

## 引言

「叠美」成立于2005年，至今完成国际星级酒店饰装饰若干。拥有10年的灯饰设计和制造经验，精湛的工艺，让我们在工程上实现很多大胆的创意。每个创意都是对瓶颈的突破，由经验丰富的师傅精心完成。匠心精神，把简单的事做到极致。用心做一件事情，这种来自内心的热爱，源于灵魂的本真，只是单纯的把一件事情做到极致。

叠美延续的精益求精的匠心精神，在经历时间长河的积累和沉淀后，如今已渗透到了企业到每一寸土壤中，包括这片土壤上到每一个人心里。每一位匠人的精雕细琢成就了叠美到高品质，他们将自己的手艺温度蕴藏在产品之中，形成了叠美产品外形下不可复制的神韵和尊贵气质。

叠美对灯饰的热情和对创新的不断追求，成就了我们当今灯饰市场独特的地位。



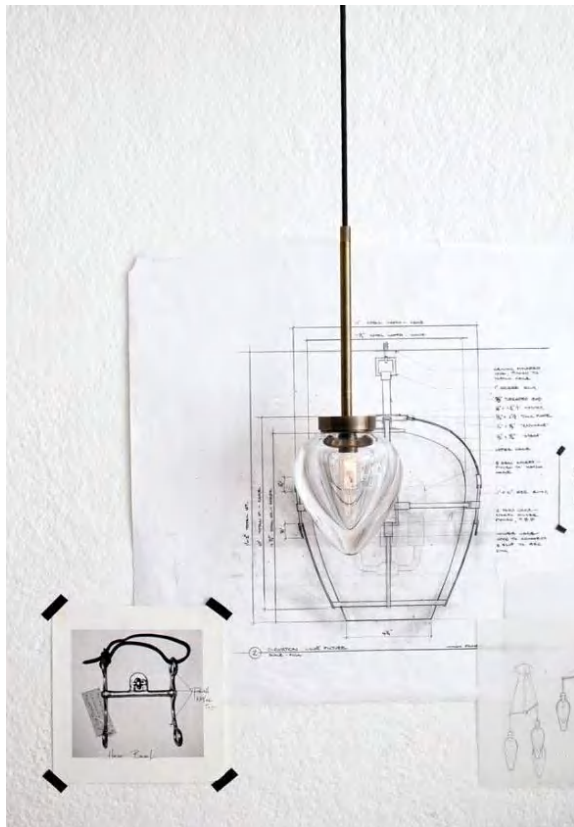

## COLLECTIONS

Artistry, craftsmanship and tradition associated,  
Tradition, fashion and international ideas,  
An ingenious designer.  
A skillful craftsman.  
Emotions and skills.  
Such are the DM Collections.

## 集合

艺术、工艺和制造技术，  
传统、时尚和具有国际性的创意，  
匠心独运的设计师。  
心灵手巧的手艺人。  
情感和技能。  
这就是「叠美」集合。





## MISSION

**Dream with real moments. Be one with the moment.**  
**Play with magic moments. Believe in the impossible moments.**  
**Create unique moments. Find your defining moments.**  
**Embrace the simple moments. Defy the irreplaceable moments.**  
**Feel genuine moments. Make the unexpected moments.**  
**Imagine exceptional moments. Seek the perfect moments.**  
**Design your own moments. Change the moment.**  
**Think about extraordinary moments. Enjoy the remarkable moments.**  
**Do the challenging moments.**

## 使命

真正的梦想。活在当下。  
在神奇的时刻。相信不可能的瞬间。  
创造独特的时刻。找到你决定性的时刻。  
拥抱简单的瞬间。挑战不可替代的时刻。  
感受真实的瞬间。制造意想不到的瞬间。  
想象非凡的时刻。寻找完美的时刻。  
设计自己的时刻。改变这一刻。  
思考一下不寻常的瞬间。享受精彩的时刻吧。  
做些有挑战性的事。

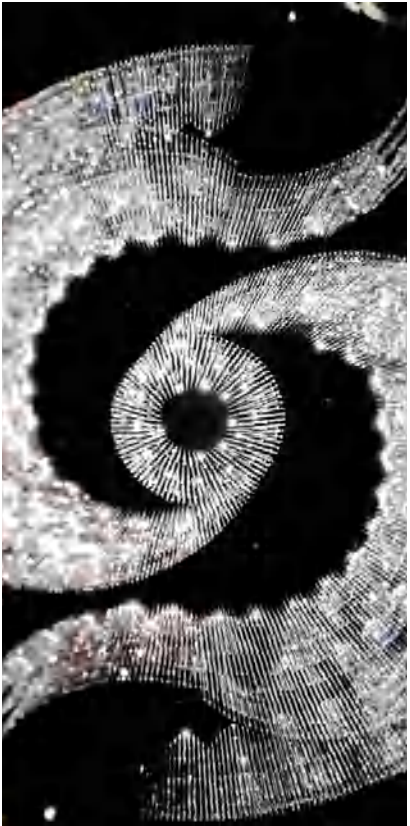





DM  
LIGHTING  
匠心叠美

这里所呈现的，不仅是产品，  
更是对设计的真诚。





## 一颗完美主义的制造心

/细/节/决/定/高/度/

---

手工打造各种金属材质和吹制玻璃，  
尽显材质的珍贵，  
使得作品拥有流畅和时尚的造型。



# 综合服务

COMPREHENSIVE SERVICE  
IS A TOPMOST PRIORITY

定制-让你的天马行空，不再仅存脑海；  
让你有关设计的期望，触手可及。

「叠美」

让想象着陆，艺术起航。

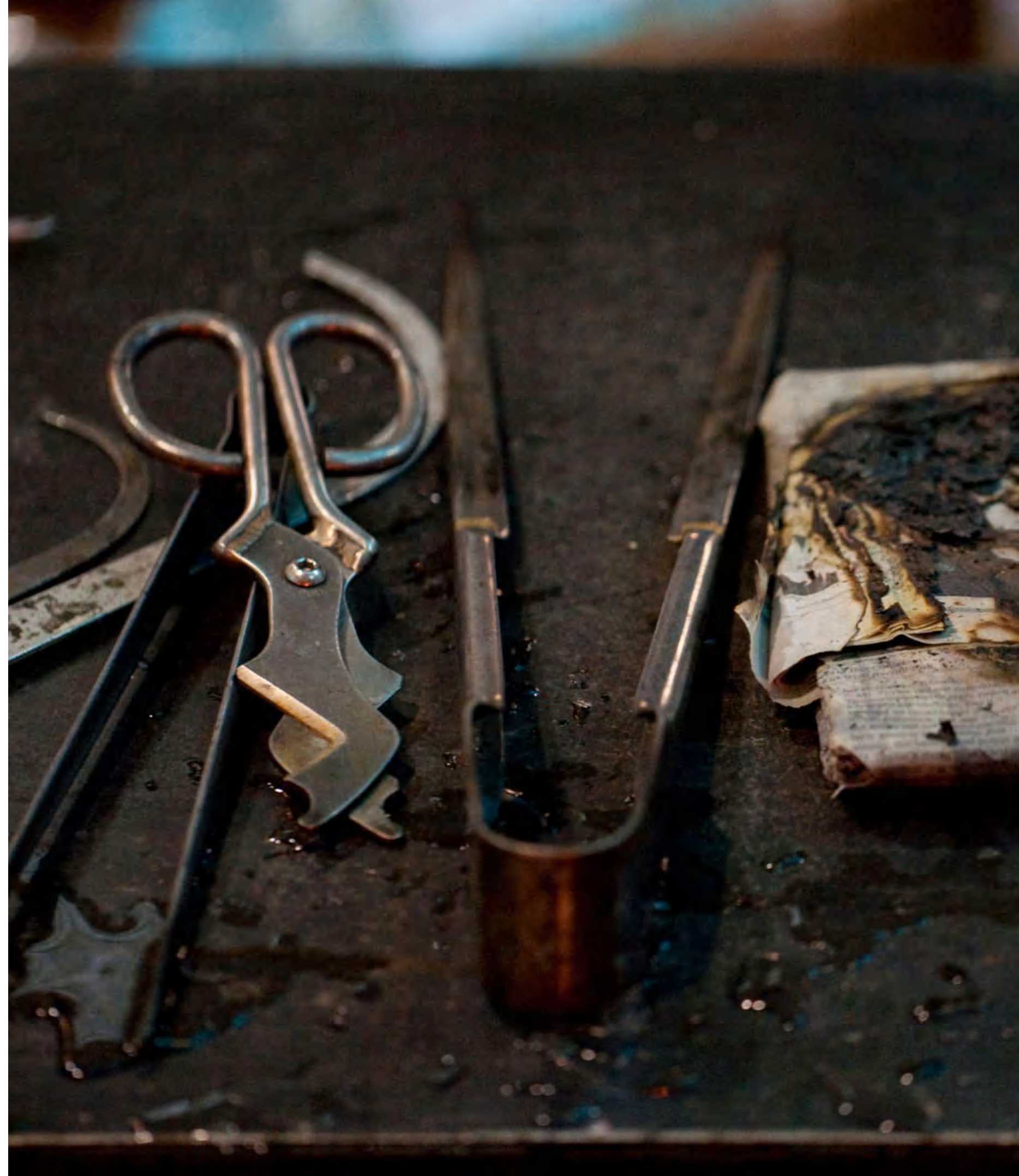





设计

DESIGN

Our artists create sophisticated designs for chandeliers in the form of hand sketches or computer-aided visualizations, based either on their own ideas or our customers' specifications.

我们的艺术家借助计算机和手绘草图，为客户量身定做项目需要的灯饰。

生产

PRODUCTION

Our advanced design methods are based on computer-processed technical and production documentation.

我们借助先进的计算机技术深化和生产。

安装

INSTALLATION

The manufacturer's detailed installation instructions are a standard part of each lighting fixture. The assembly and installation itself can also be carried out by our highly qualified team of site engineers.

灯饰的每个标准部件有详细的安装图纸，由我们高素质的现场工程师团队来完成。

维护

MAINTENANCE

Delivery is not the end of our cooperation – regular on-site maintenance and professional cleaning round out our service package.

送货并不是我们合作的终点——定期上门维修和专业的清洁完善了我们的服务。



项目展示

PROJECT DISPLAY







INTERCONTINENTAL.

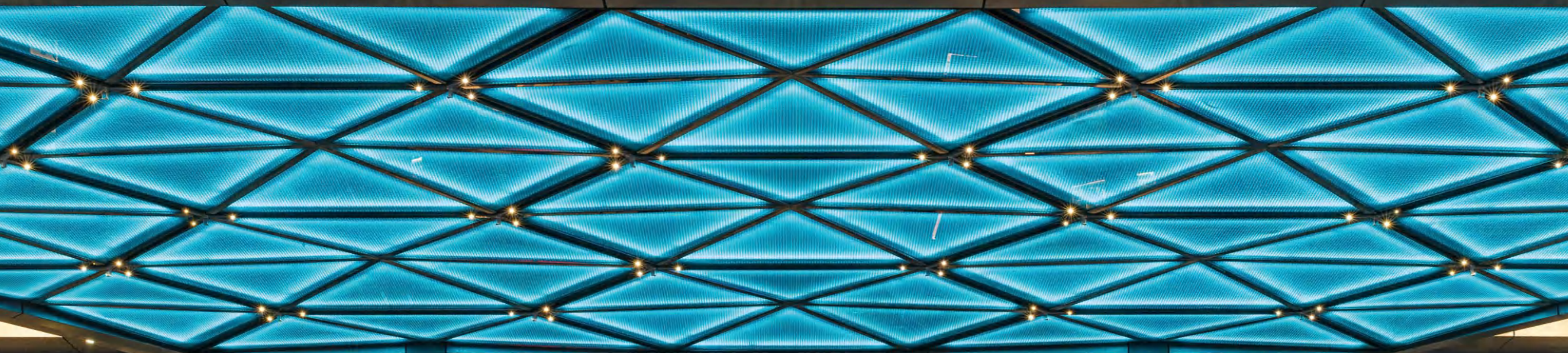

INTERCONTINENTAL



# 项目名称：北京三里屯通盈中心洲际酒店

项目地点：中国北京 | 项目时间：2015年2月

The hotel design inspiration comes from the building facade hexagonal diamond elements, through the analysis of diamond formation: from the rough ore of the original stone refining, eventually form a fine diamond;The design USES the cut and shine of the diamond to shape the space, from the architectural sense of the plane layout to the details of the facade throughout the original intention.

"New yuppie, New Yuppies" interior design style of the hotel. The reason why I say "new" is because in the past, when speaking of yapi, I tend to associate it with positive, self-confident and calm.Gentle and elegant, the pursuit of fashion life, but often only black and white gray color. Sanlitun intercontinental is creating a new yapi style: still pursuing and even leading the fashion trend, butTonal it is not only black and white ash however, make with gem blue even give priority to tonal, build futuristic the avant-garde atmosphere that feels concurrently science and technology.

The interior design tries to be consistent with the architectural design, and makes full use of the space of existing buildings for redesign, so as to create a reasonable layout, convenient use, comfortable and elegant.And is advantageous to the management interior space.

酒店设计的灵感来源于建筑外立面六边形钻石的元素，通过对钻石形成的分析：由粗矿的原石不断提炼，最终形成精美的钻石；设计运用钻石的切割及光泽的特点来塑造空间，从建筑感的平面布局到立面的细节都贯穿这一初衷。

室内设计“新雅皮，New Yuppies”风格的酒店。之所以说“新”是因为以前一说到雅皮容易联想到的是积极上进、自信坦然、温文尔雅、追求时尚生活，但色彩上却往往只有黑白灰。三里屯洲际打造的是新雅皮风格：依然追求甚至引领时尚潮流，但是色调却不是只有黑白灰，甚至用宝石蓝作为主色调，营造未来感兼科技感的前卫氛围。

室内设计力图与建筑设计的思想一致，并充分利用现有建筑的空间进行再设计，以创造出一个布局合理、使用方便、舒适高雅，且有利于经营管理的室内空间。















INTERCONTINENTAL  
BEIJING SANLITUN  
北京三里屯凯悦中心附楼酒店

INTERCONTINENTAL  
BEIJING SANLITUN  
北京三里屯凯悦中心附楼酒店



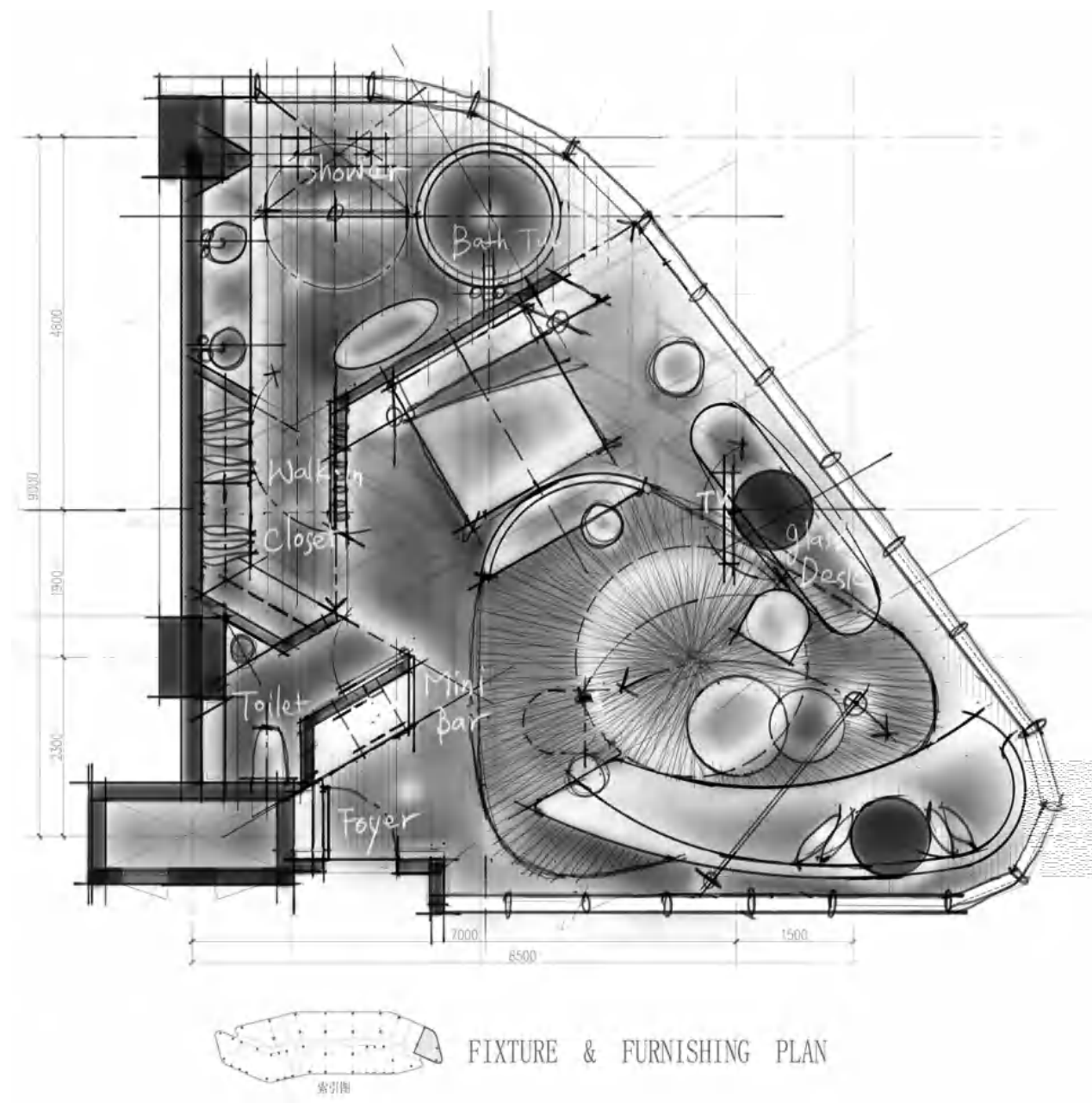







# 项目名称： 襄阳星澜华美达酒店

项目地点： 湖北襄阳 | 项目时间： 2018年12月

World famous architect saarinen once said: "architecture is an open book, from which can see the ambition of a city. Whether commercial hotels or residential buildings, all determine the style of a city, the interpretation of the city in each period of development needs and direction. Mountain climbing, then know how high the mountain; Wade, and know the depth; Appreciate the scenery, and then know its wonderful. Everything you've been exposed to along the way is enough to make you re-examine yourself with another perspective. Located in xiangyang xiangzhou district diamond avenue and high-tech zone dongfeng avenue intersection. At present, xiangzhou hotel is the highest level of an international brand luxury hotel in xiangzhou district and the high-tech zone. In addition to improving their horizon, they also make elite social life a daily routine.

世界著名建筑师沙里宁曾说过：“建筑是一本打开的书，从中可以看到一座城市的抱负。”无论是商业酒店还是人居建筑，都决定着一座城市的格调，演绎着城市在每个时期发展的需要和方向。登山，而后知山高；涉水，而后知水深；赏景，而后知其妙绝。一路上所接触过的一切，足以让你用另一种眼光重新审视自己。位于襄阳市襄州区钻石大道和高新区东风大道交汇处。目前酒店是襄州区和高新区档次最高的一家国际品牌豪华型酒店，也是该地区酒店业一面崭新的旗帜。在提升自身眼界格局的同时也让菁英社交生活成为日常。



























# 项目名称：上海中心大厦米其林餐厅

项目地点：中国上海 | 项目时间：2018年5月

The French dining experience at 314 meters in the air the design space in the style of montrian -- enter from the west gate of Shanghai center, take the elevator to the 68th floor, the handsome and shy restaurant manager greets us step into the dining room and ask nicely if you're visiting Maison Lameloise for the first time. The screen of montelyan style, have red, yellow, blue geometrical color piece set off each other, integral modelling god secret and abstract, simple primary color collocation and restaurant "pure" concept just fit. Maison Lameloise from France to Shanghai, who want everything to be "copied", Classic meals, environment, service, you don't have to fly to shani to enjoy it all. For example: classic dinner plate is the same style with France, all from the same French artist meter; In Fine Dining room, you can enjoy the same comfort and privacy as at home. The dedication to work from France has not changed. Be sensitive to Numbers pedestrians know that a three-michelin-starred restaurant cannot have more than 60 seats, considering the privacy and standardized service of diners. I counted 60 seats in the dining room. When having a meal, also do not allow temporarily add chair absolutely, right, be so rigorous.

314米高空的法式用餐体验蒙特里安风格的设计空间——从上海中心西门进入，坐电梯直升**68**层，帅气又腼腆的餐厅经理，迎我们步入餐厅，并贴心地询问，是否第一次来**Maison Lameloise**。蒙特里安风格的屏风，有红、黄、蓝几何色块相互映衬，整体造型神秘又抽象，简单的原色搭配和餐厅的“纯粹”理念刚好相契合。**Maison Lameloise** 从法国到上海，他们希望一切都被“复制”，经典餐食、环境、服务，不用打飞的奔去沙尼，你就能享受这一切。比如说：经典餐盘是与法国同款，均来自同一位法国艺术家设计；在**Fine Dining**餐厅里，能够享受在家一样的舒适私密感，也没变；来自法兰西的执着工作精神，更没变。对数字敏感一点的内行人都懂，考虑到食客用餐的私密性与标准化服务，米其林三星餐厅标准，是不能超过**60**张位的。数了下，餐厅里恰好摆放**60**张位，用餐时，也绝对不允许临时加椅，对，就是这么严谨。

























## 项目名称：武汉绿地中心总裁公馆

项目地点：湖北武汉 | 项目时间：2018年5月

Wuhan Greenland Center, a super high-rise landmark skyscraper in Wuhan, China, is designed to reach a height of 636 meters. Shanghai Jinmao Tower and many other world famous super high-rise architectural design team - the United States AS+GG architectural design firm design and construction; One of the floors arrives in the lobby, and the 66th floor is big in the air the interior design of the hall, executive lounge and multi-function hall, the reception area on the 11th floor and the President's residence on the 76-85 floors was completed by CCD Hong Kong zheng zhong design office. The project is located in wuchang binjiang business district, The core area will become a super high-rise urban complex integrating super five-star hotels, high-end shopping malls, top office buildings and apartments.

武汉绿地中心（Wuhan Greenland Center）是中国武汉市的一座超高层地标式摩天大楼，设计高度**636米**，由曾主持设计迪拜塔、上海金茂大厦等多个世界著名超高层的建筑设计团队——美国**AS+GG**建筑设计事务所设计建造；其中一层抵达大堂、**66**层空中大堂、行政酒廊及多功能厅、**11**层接待区以及**76-85**层总裁公馆的室内设计由**CCD**香港郑中设计事务所完成。项目位于武昌滨江商务区核心区，建成后将成为一个集超五星级酒店、高档商场、顶级写字楼和公寓等于一体的超高层城市综合体。











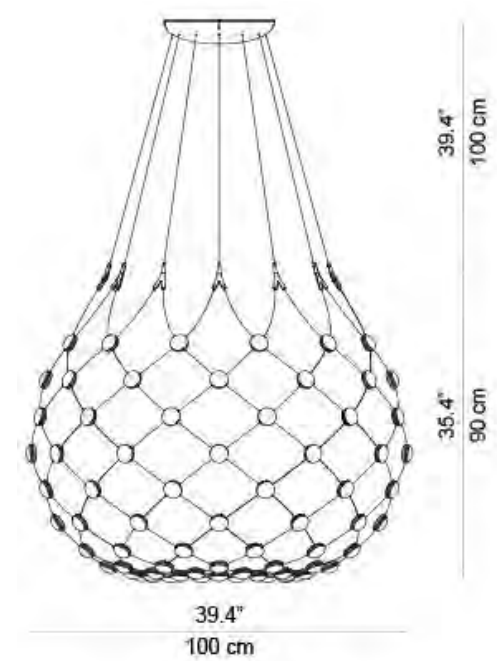















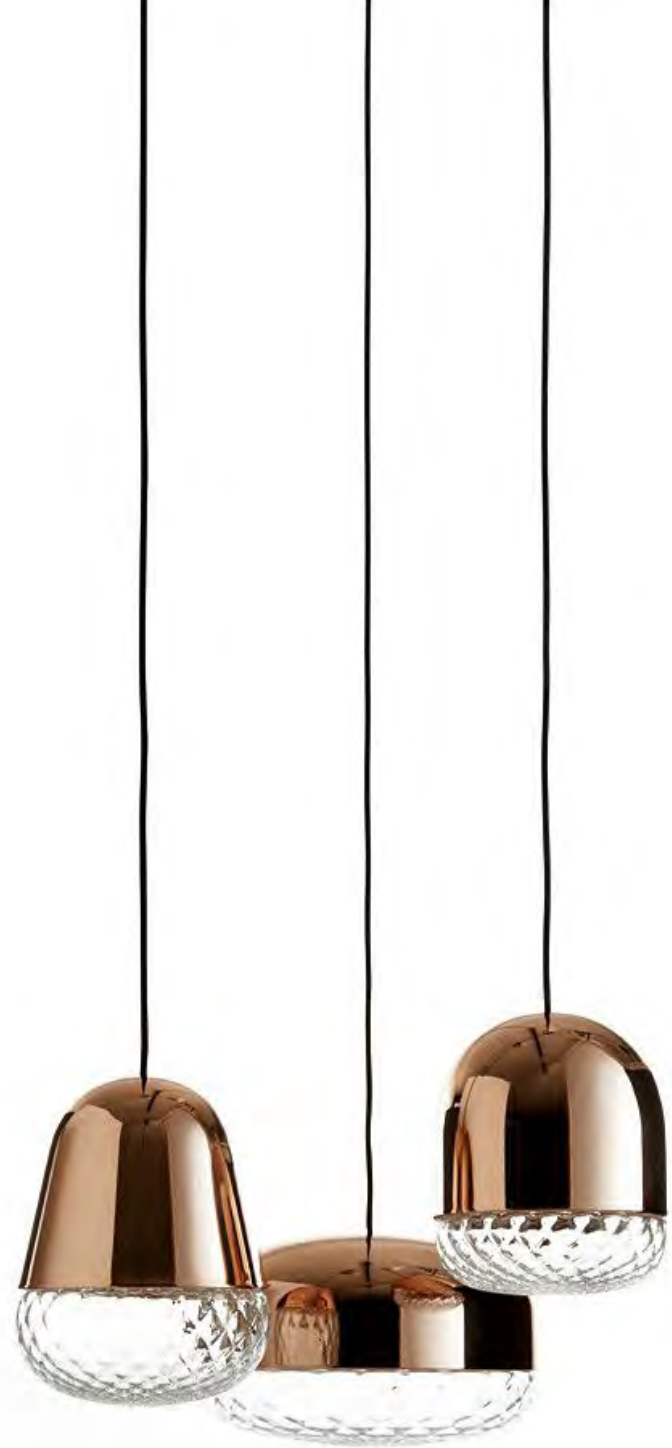













休息区座位疏密分布，有的布置在朝向落地窗景观前，可直面长江天目，阳光透过玻璃幕墙投射在大地色的地毯上形成斑驳若树荫的疏影。





艺术品：绿地

灵感来自“绿地”名字和项目的地理位置引发的设计构思，因此通过以半透复合材料进行艺术手法塑造成水面，每一处起伏的细节，都通过设计师与匠人合作，追求水波荡漾的自然感，局部金箔做波光粼粼的点缀。整体色彩在灯光辅助下散发出碧玉的通透质感，当夕阳西下，江面白浪翻翻波光粼粼的美景与艺术品遥遥呼应，美景自然天成，呼之欲出如水面浮出的玉璧。





# 项目名称：马尔代夫维拉瓦鲁悦椿度假村

项目地点：马尔代夫 | 项目时间：2011年10月

The AngsanaVelavaru Maldives Resort, which is a Resort under the ansana brand, is referred to as "the AngsanaVelavaru Maldives Resort". Part of the resort is located on the island of villavalu, and part of it is on the water next to it, known as the "pavilion in the water". The entrance to the pavilion in the water is also a reef in the bottom to spell out the logo of the resort, the logo can be seen in the clear water. The beauty of maldives is absolutely inseparable from the dedication of the beach, the sea seems to be a strong teenager, the beach is like a gentle woman, Weave a romantic picture together. Here you just enjoy the maldives beach and sunshine bring you another kind of comfortable. She is like a gentle and quiet girl, Her serene beauty adds a touch of aura to this wonderland, offering breathtaking views of the Indian Ocean coast. It is truly called "peach garden in the sea". All ocean villas are built on coral reefs off the island. Each ocean villa is 2 stories high, spacious and equipped with infinity pool. Long in the city life, every day for work busy rush about, really want to find a place to rest and relax. I knew this was the place I was looking for when I arrived on the island of villavalu. Here is no noise, no traffic, no tall buildings, there is only a quiet environment, the vast sea, brilliant dream of a better life. It's like a dream. I really don't want to wake up.

薇拉瓦鲁悦椿度假村（AngsanaVelavaru Maldives Resort）又被称为“薇拉瓦鲁阿格桑娜度假村”，是安莎娜品牌下属的度假村。度假村的一部分坐落在薇拉瓦鲁岛上，一部分在旁边的水上，被称为“水中阁”。水中阁的入口处还用礁石在水底拼出了度假村的标志，标志在清澈的水中清澈可见。马尔代夫的美绝对离不开沙滩的奉献，海水仿佛是一位强壮的少年，沙滩恰似一位温柔的女子，共同织出一幅浪漫的画面。在这里您只要尽情的享受马尔代夫沙滩和阳光带给你的别样惬意。她犹如一位温雅文静的女孩，她宁静的美为这个仙境增添了一缕灵气，让人尽享印度洋海岸的秀美景色。真不愧被誉为“海中桃园”。所有海洋别墅均建在岛旁的珊瑚礁上。每栋海洋别墅都有2层高，空间宽敞且均配有无边泳池。久在城市中生活，每天为工作忙碌奔波，真的好想找一个地方休息、放松。到了薇拉瓦鲁岛，我就知道这个地方是我要找的地方。这里没有喧嚣、没有车水马龙、没有高楼大厦，有的只是宁静的环境，广阔的大海，烂漫梦幻的美好生活。在薇拉瓦鲁岛享受惬意的度假生活，就像做梦一样，真的不想梦醒。

















# 项目名称：塞舌尔悦榕庄

项目地点：塞舌尔共和国 | 项目时间：2009年6月

The seychelles resort is a beautiful and natural place, located on the southwest coast of the island of mahe. It is also home to rare plants and animals on earth. The local people try their best to preserve the original local traditions and culture. The resort is dominated by seychelles architecture. It combines the French and British styles of the colonial period to create a casual and elegant atmosphere. Like a paradise on earth, seychelles will show you swaying palm trees, Lush tropical rain forests and golden beaches. Despite stepping foot in this pure natural and beautiful archipelago, you can enjoy the magnificent Indian Ocean scenery here. And the native takamaka tree. The banyan tree resort in the seychelles is ideally placed in the indo-danse bay archipelago. Nestled along the winding coast, the seychelles megalithic pool house is nestled with artistic formations of boulders and tropical plants, as if to prove to the traveler, Nature is the best architect. As it faces the waves of the megalithic coast, people can always enjoy the rare scenery in their homes. In addition, the villa is located in the open-air dining pavilion, hidden pool and comfortable massage pool are integrated with the magnificent natural landscape.

塞舌尔度假村是一处美丽迷人、自然纯真之地，它位于马埃岛西南海岸线，是一座历史悠久的自然博物馆，也是地球珍稀动植物栖息地。当地居民，竭尽全力保留本地原汁原味的传统和文化。度假村以塞舌尔建筑为主，融合了殖民时期的法式和英式风格，营造出休闲而优雅的氛围。塞舌尔仿若人间天堂，带您领略随风摇曳的棕榈树，郁郁葱葱的热带雨林，金光灿灿的热情海滩。尽管踏足这片纯真自然的美丽群岛，在这里，您可以观赏风景壮丽的印度洋，还有土生土长的塔卡马卡树。塞舌尔悦榕庄奢华度假村坐落在因藤丹斯湾，四周群岛环绕，可谓得天独厚。位于蜿蜒的海岸旁，塞舌尔巨石泳池别墅被各种艺术形体的巨石和热带植物依偎，仿佛时刻在向旅行者证明，大自然是最好的建筑师。由于这里正对着巨石拍浪的海岸，因此人们随时可在居所内欣赏到平日难得一见的风光。此外，别墅位于露天的餐亭、隐秘泳池及舒适按摩浴池均与大自然壮美的景观融为一体。

















# 项目名称： 檳城香格里拉沙洋度假酒店

项目地点： 马来西亚 | 项目时间： 2014年8月

Shangri-La's Rasa Sayang Resort & Spa, Penang is located under a canopy of 100 years of rain trees and exudes a sense of history. Above was a towering canopy of trees. The ancient thick, lush leaves seem to fall to the ground, like drops of rain, hanging in the air, into a vibrant green leaves. These centuries-old trees highlight the natural beauty of the surroundings, which is what makes this penang shangri-la shayang resort unique. There are nine very beautiful trees in the resort garden. They are the perfect gift of nature, will become a resort hotel star attractions waiting for you to find. It is full of a sense of history and the unique style of local traditions.

檳城香格里拉沙洋度假酒店座落于百年雨树葱翠的树冠之下，散发着充满历史的悠远之感。上方是高耸的树冠。古老茂密、郁郁葱葱的树叶似乎要垂及地面，犹若滴落的雨点，悬垂在半空中，化作了充满活力的绿叶。这些百年老树彰显出周围的自然之美，正是您此刻身处的檳城香格里拉沙洋度假酒店的独特之处。度假酒店花园中共有九棵非常漂亮的树。它们是大自然的完美馈赠，定会成为度假酒店的明星景点静待您去发现。此地充满了历史的悠远感，以及地方传统的独特风格。

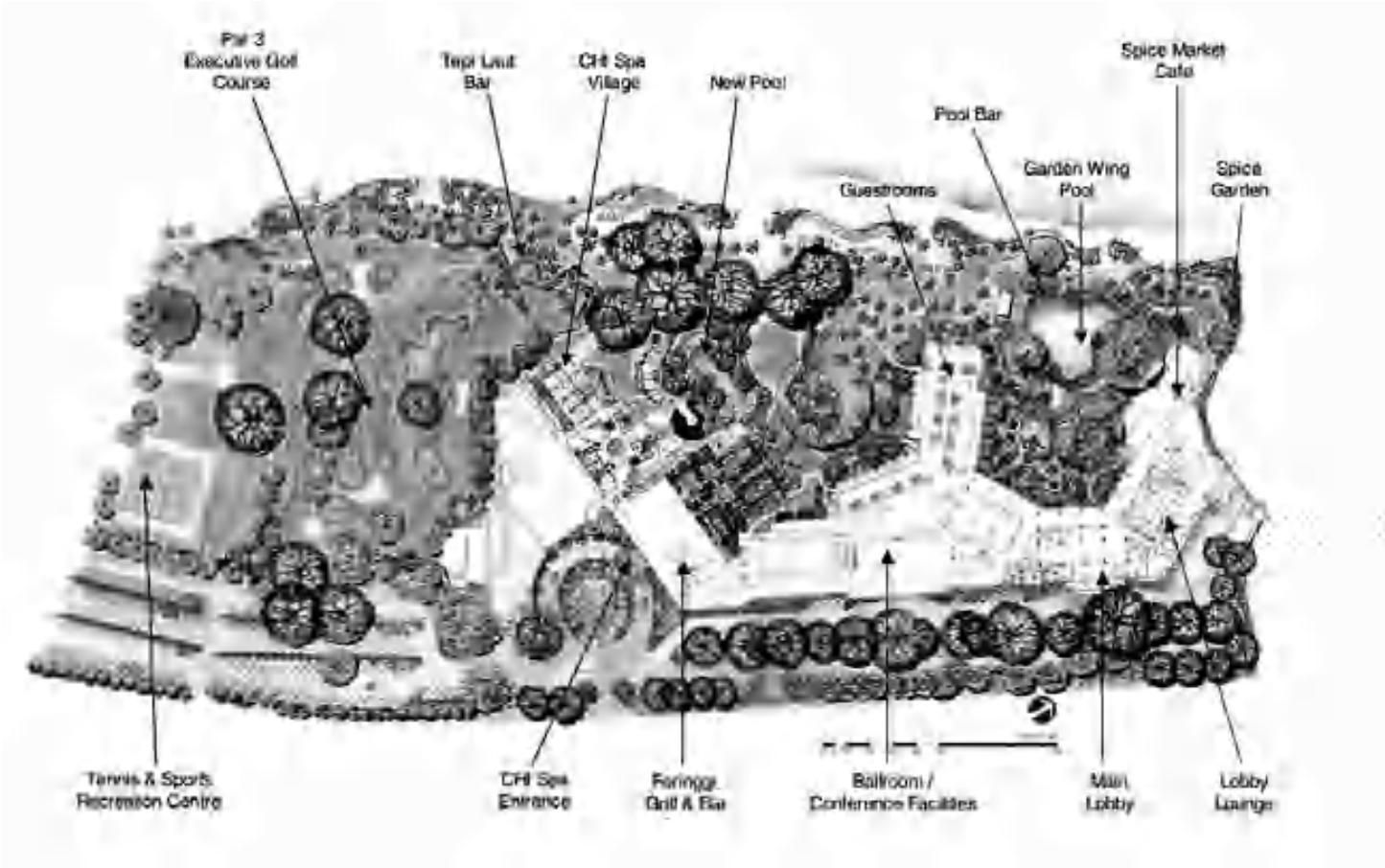

















艺术品展示

ARTWORKS DISPLAY

















































CENTRAL PARK











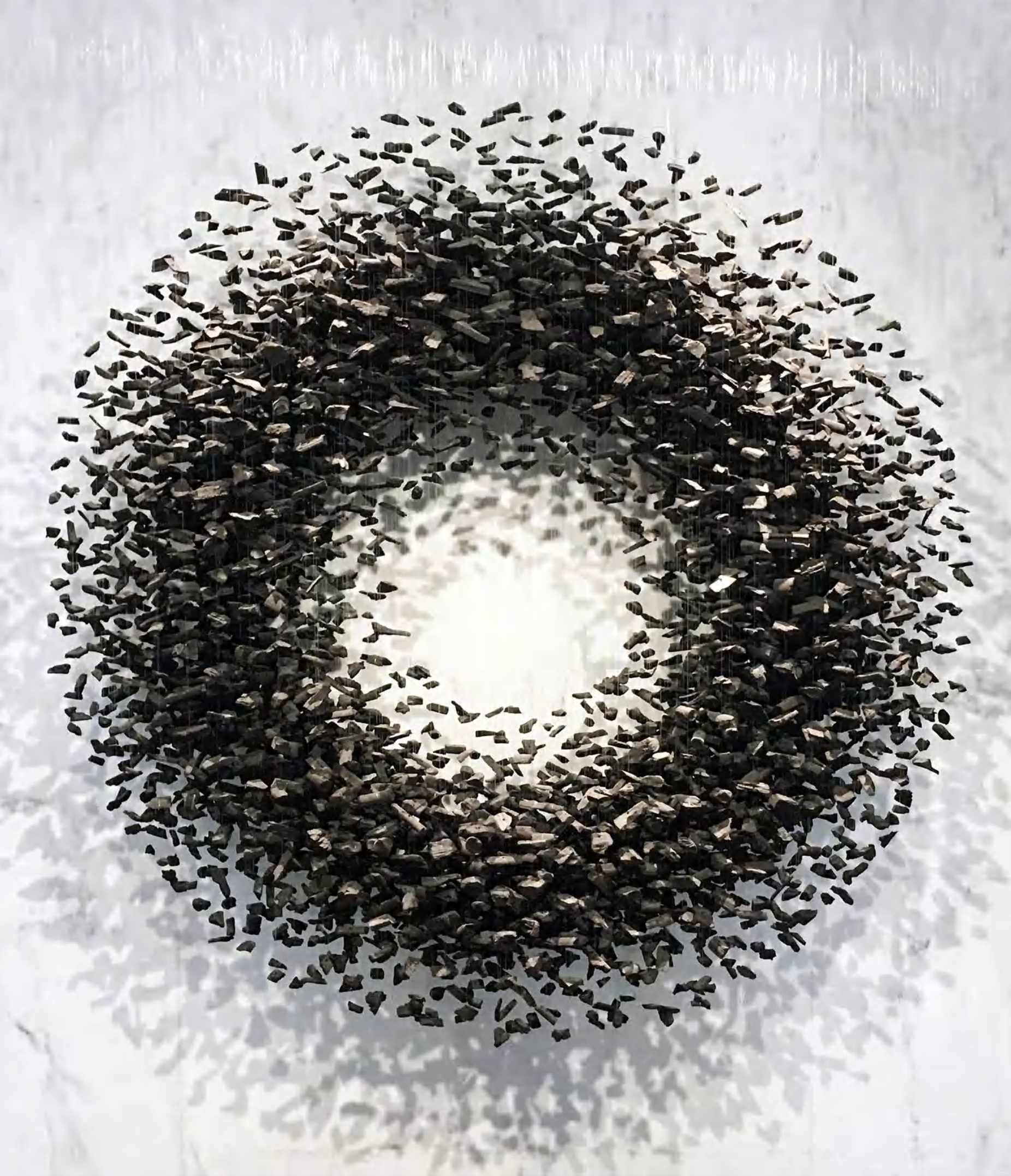



















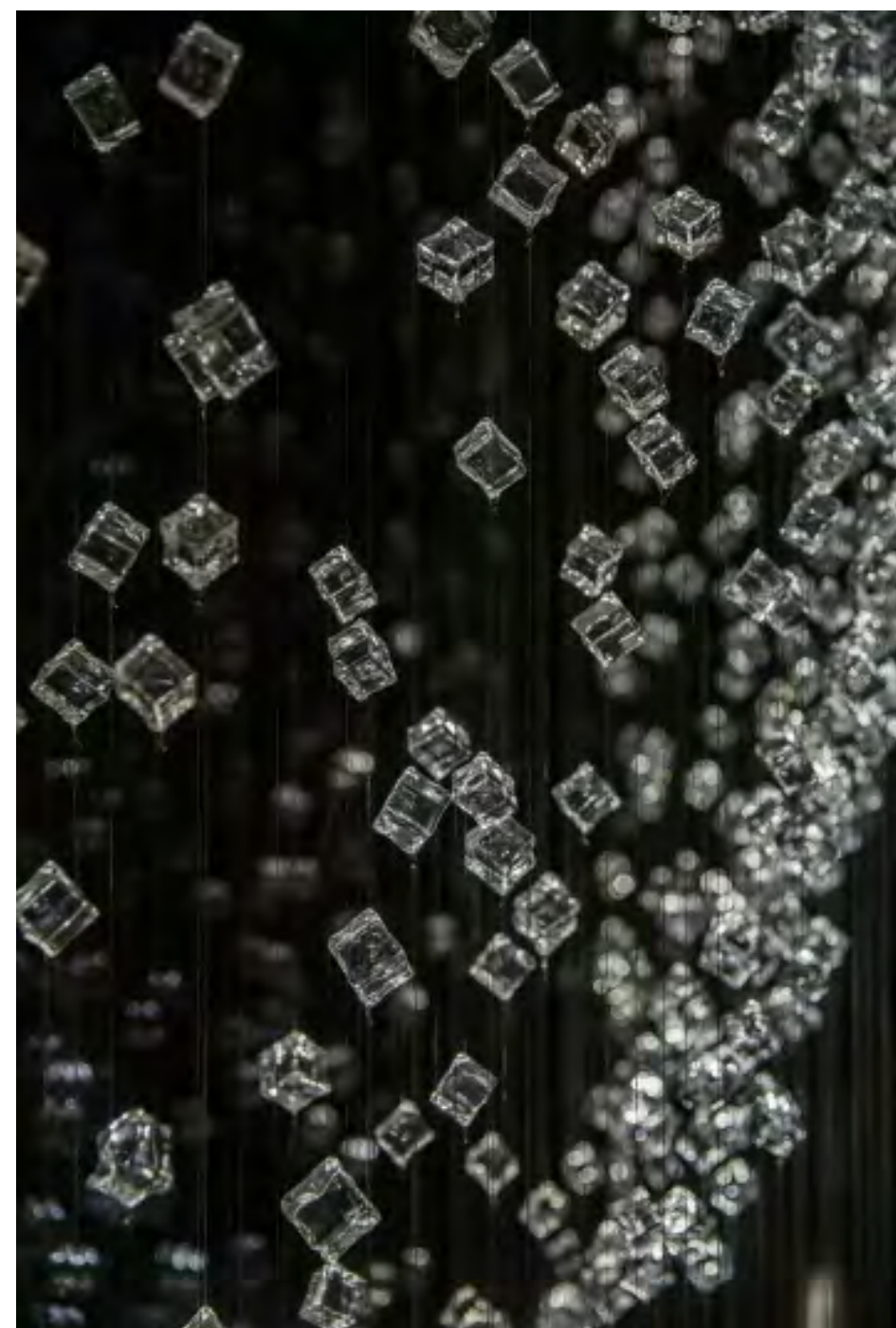







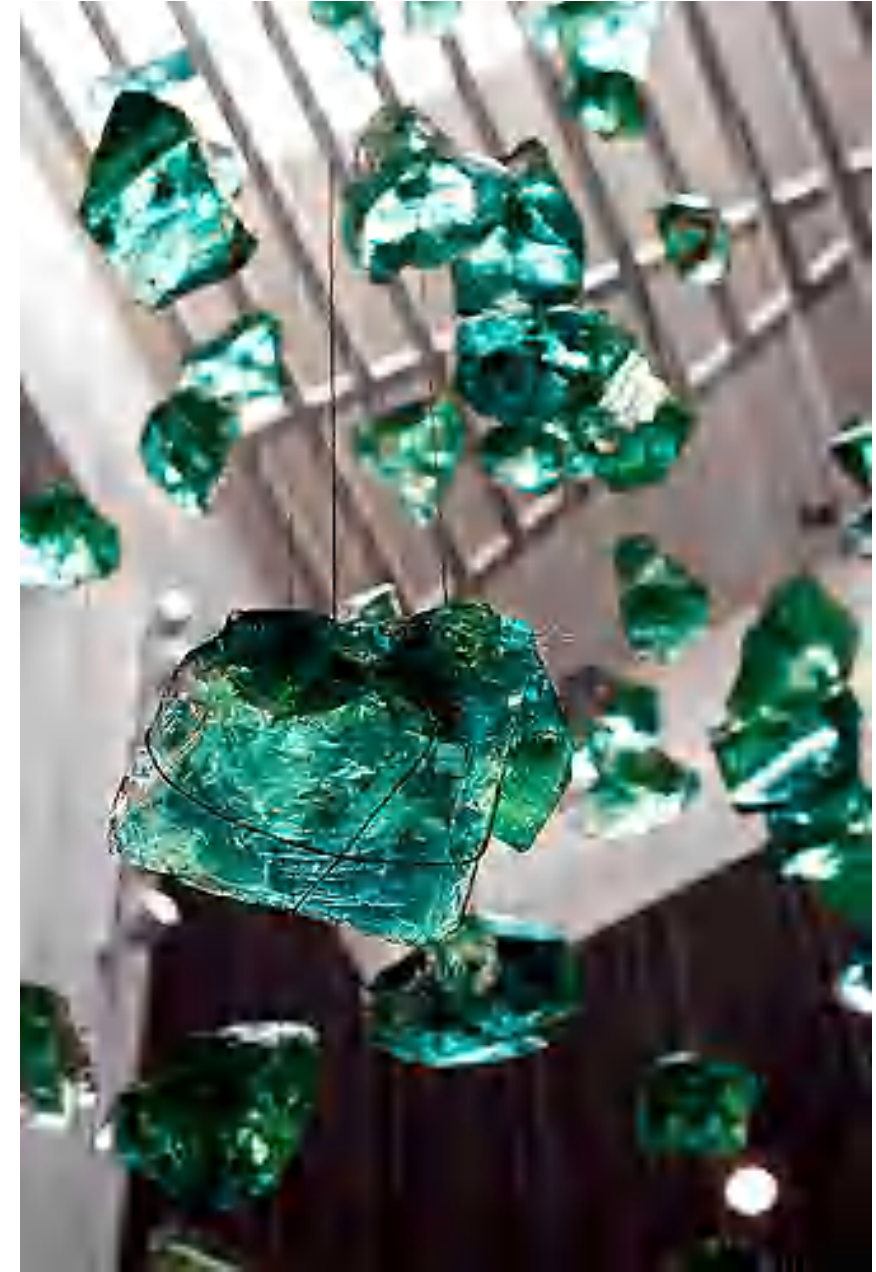
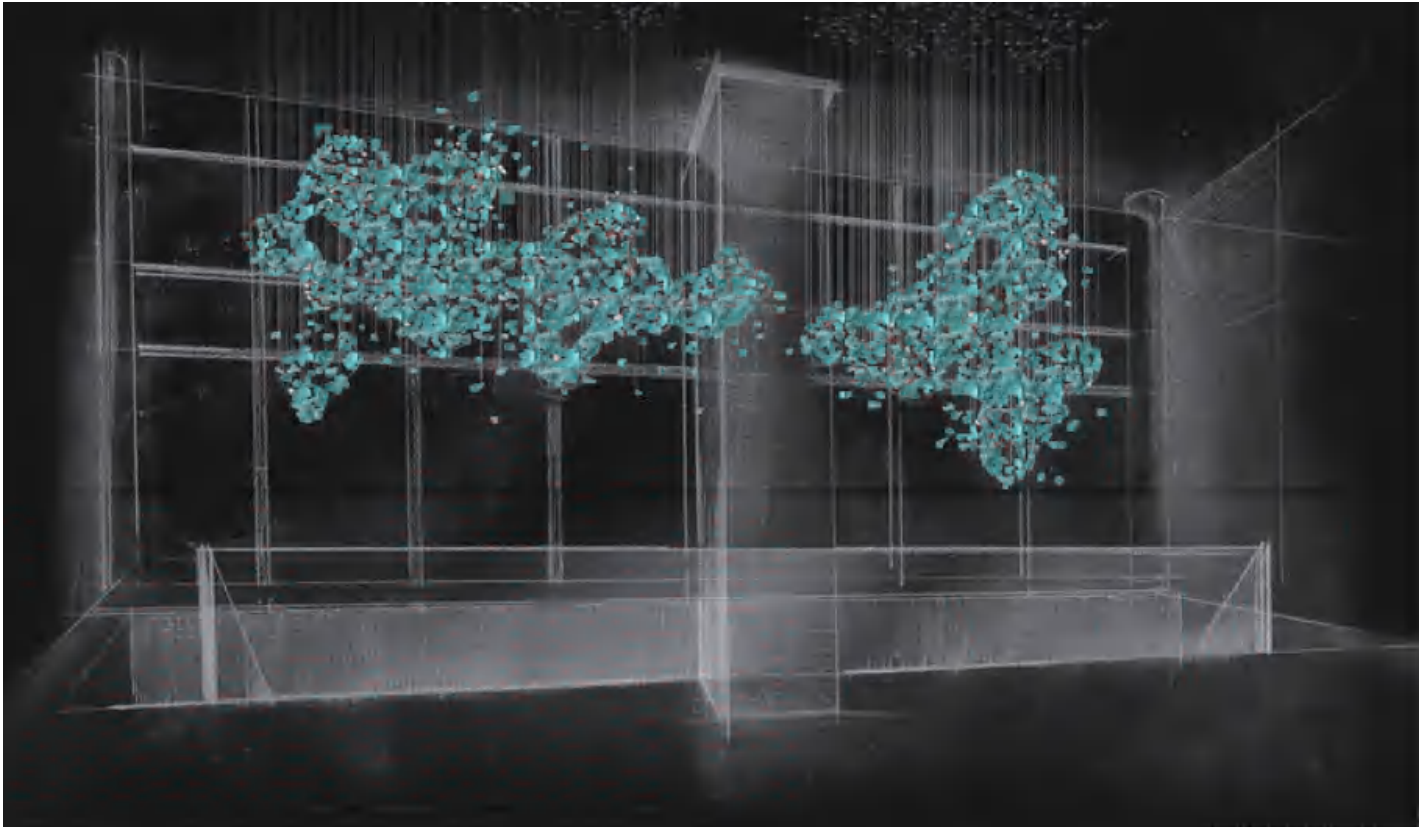















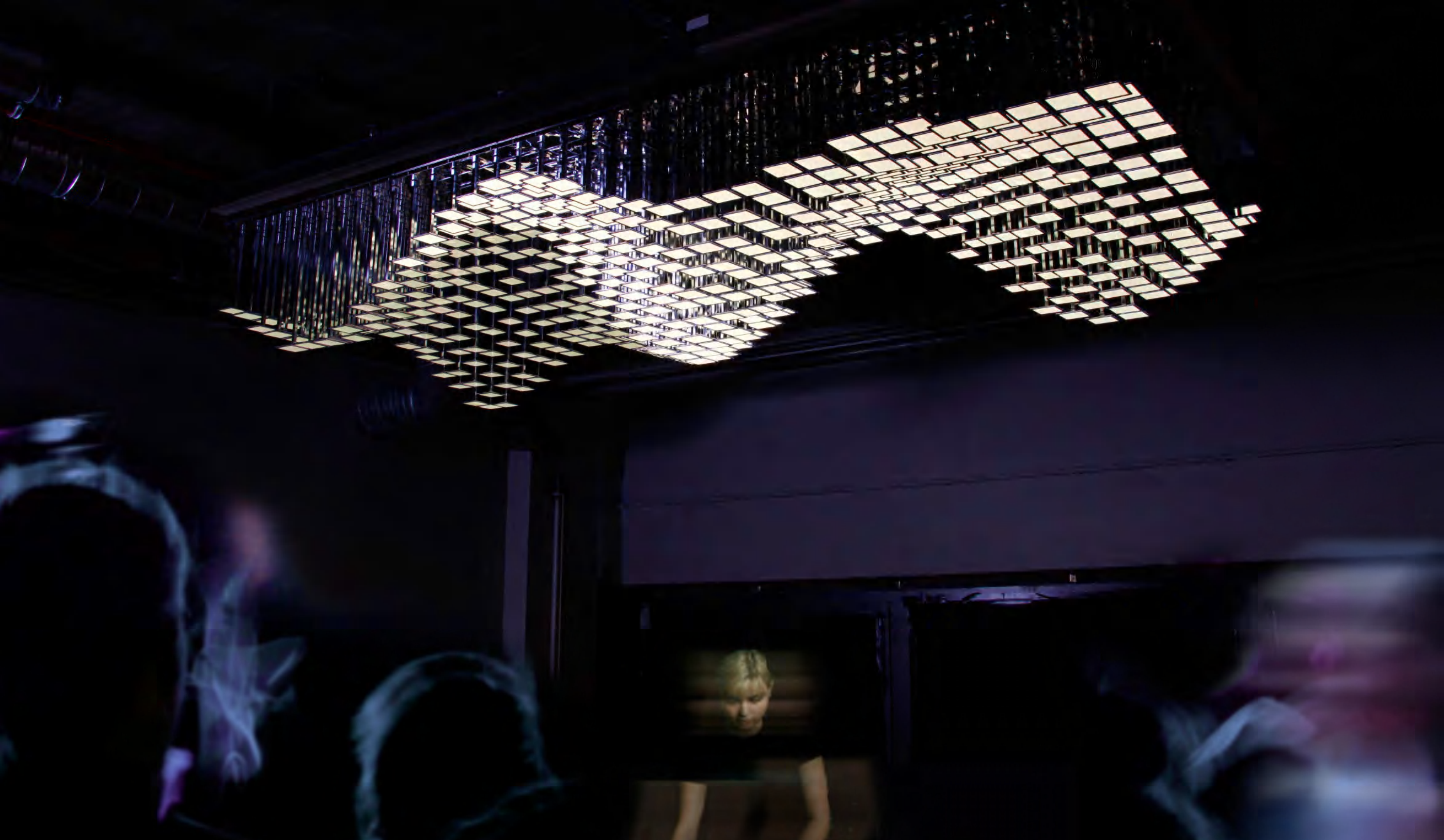



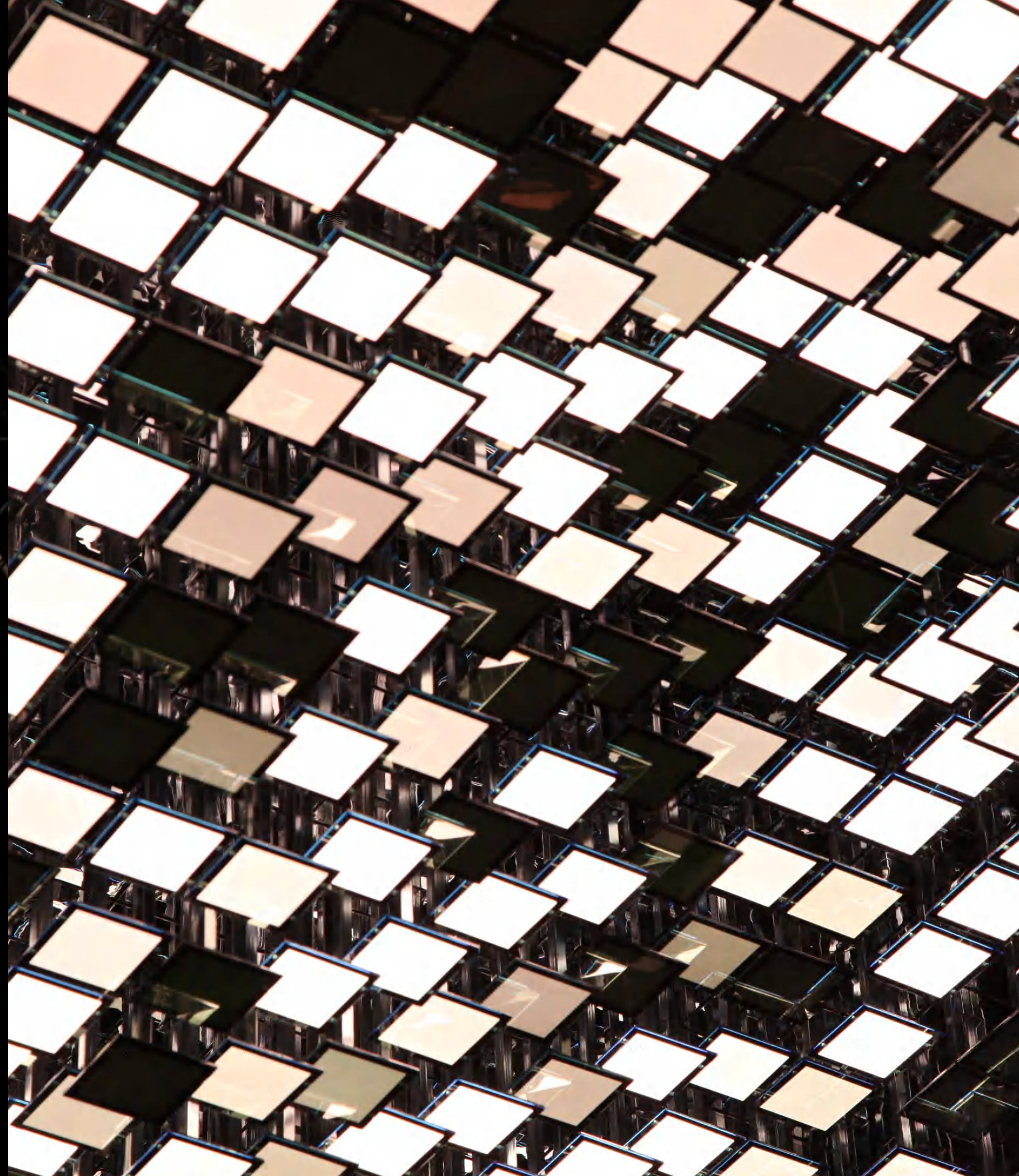
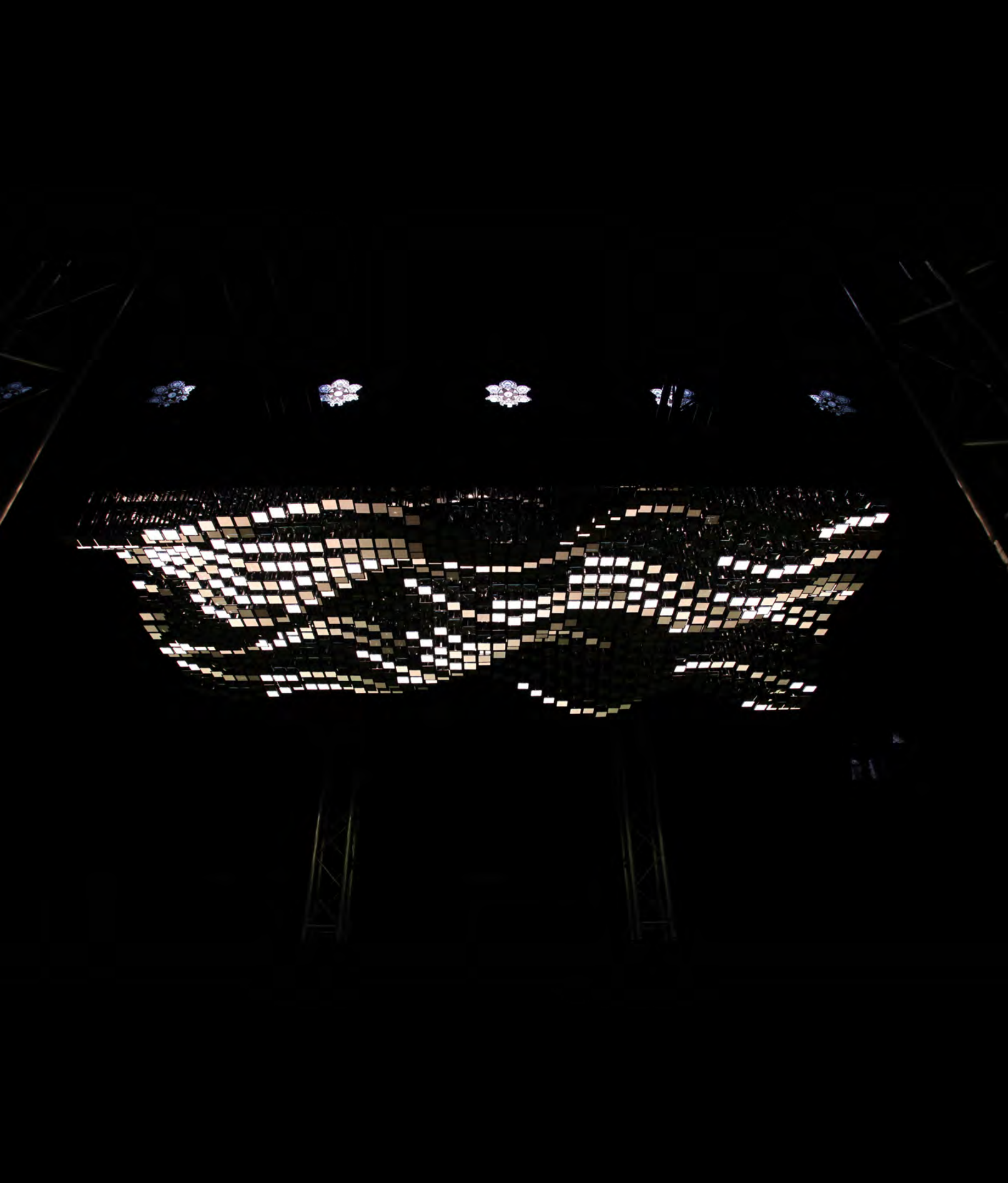



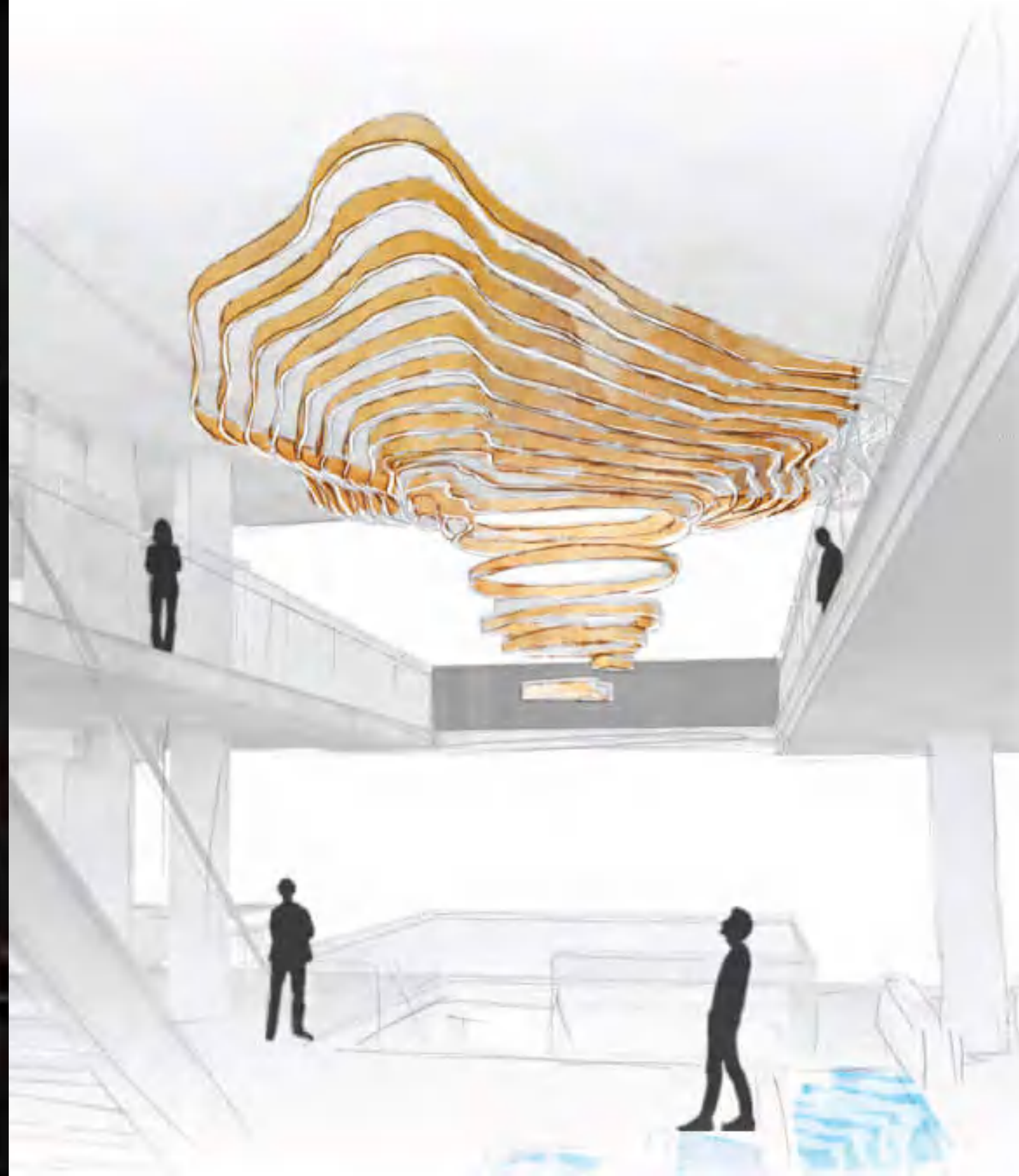











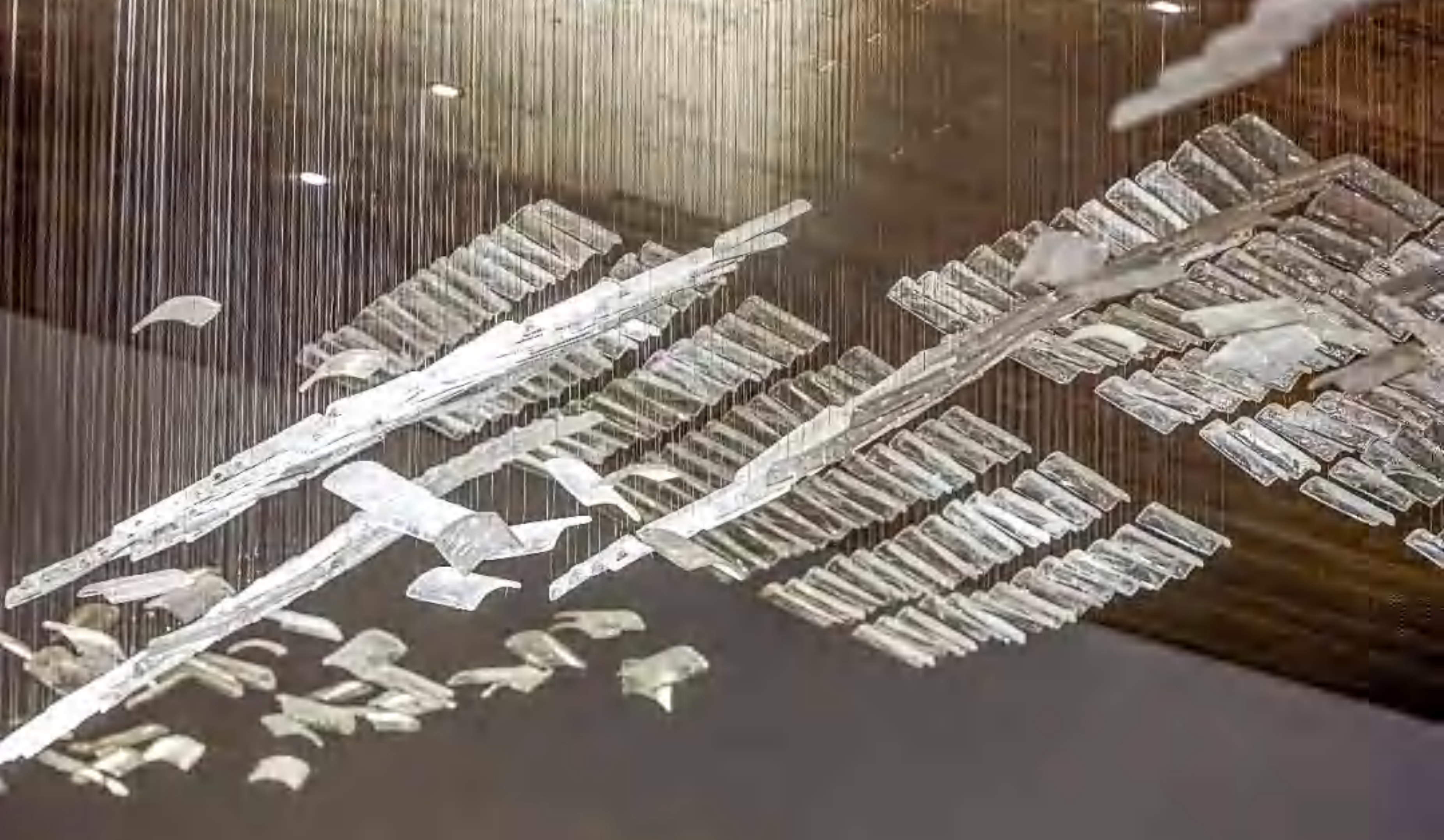



























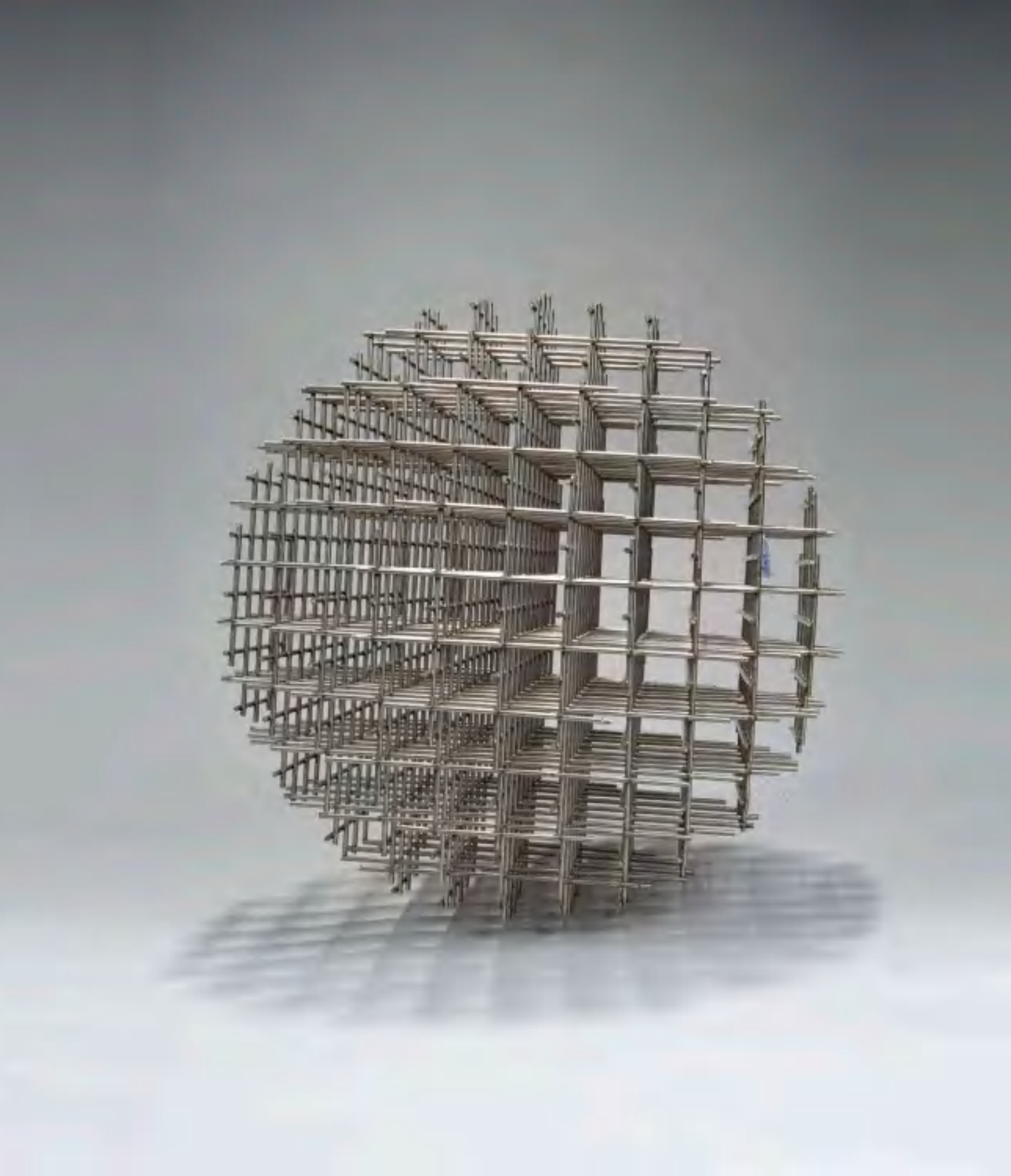











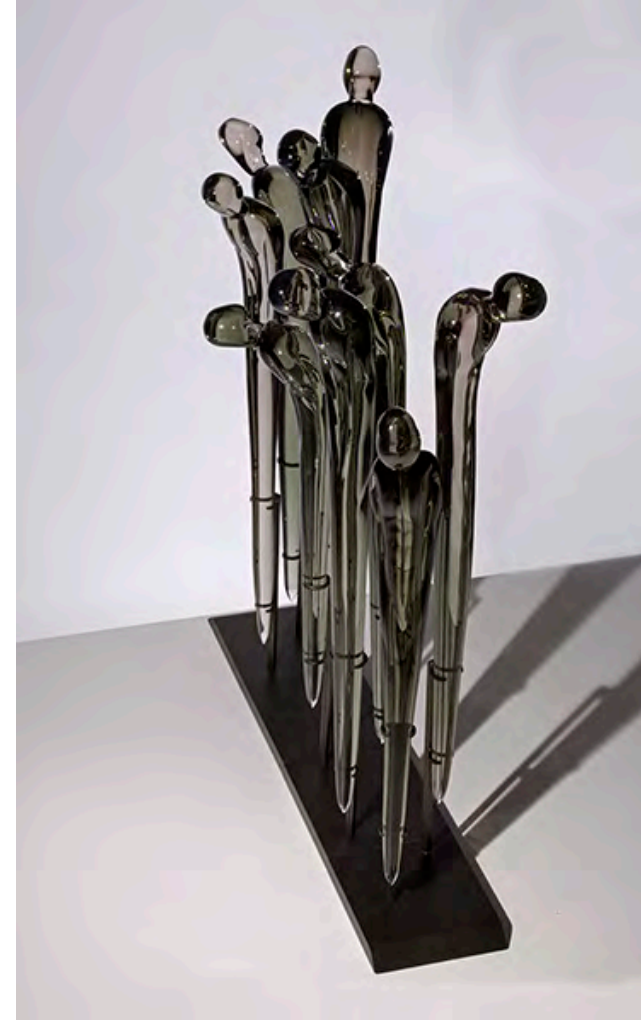







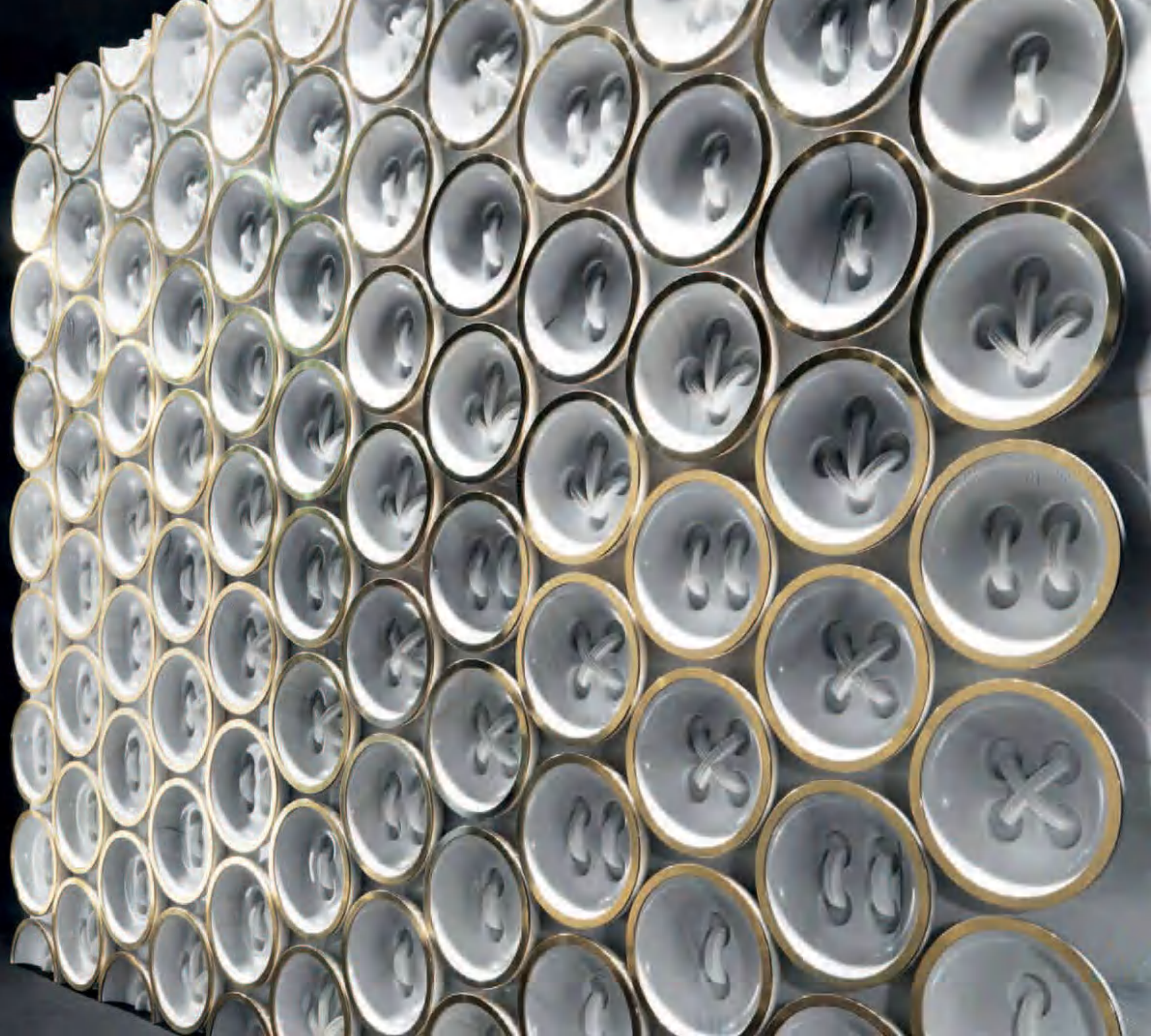















资质认证

QUALIFICATION







## 中国国家强制性产品认证证书

证书编号: 2018011001080139

委托人名称、地址

中山市古镇金美照明电器厂  
中山市古镇海洲东岸北路 213 号首层之 1

生产者(制造商)名称、地址

中山市鑫顺照明有限公司  
中山市横栏镇环镇北路 38 号华夏灯配城综合楼二楼 019 号

生产企业名称、地址

中山市鑫顺照明有限公司  
中山市横栏镇环镇北路 38 号华夏灯配城综合楼二楼 019 号

产品名称和系列、规格、型号

固定式灯具(吸顶式/吊式, 白炽灯, I 类, IP20, 适宜直接安装在普通可燃材料表面, E14)

见附件, 220V~50Hz

产品标准和技术要求

GB7000.1-2015;GB7000.201-2008

上述产品符合强制性产品认证实施规则 CNCA-C10-01:2014 的要求, 特发此证。

发证日期: 2018 年 06 月 04 日 有效期至: 2022 年 04 月 07 日

证书有效期内本证书的有效性依据发证机构的定期监督获得保持。

本证书的相关信息可通过国家认监委网站 www.cnca.gov.cn 查询



主任: 王克勤



中国质量认证中心

<http://www.cqc.com.cn>

中国·北京·西四环南路 185 号 100070

电话: +86 10 85985906

Q 1968239



## 中国国家强制性产品认证证书

附 录

第 1 页 共 2 页

证书编号: 2018011001080139

纸 号: 1968239

规格:

DM-X5 8×MAX25W, DM-X4 4×MAX25W, DM-X5 5×MAX25W, DM-X6 6×MAX25W,  
DM-X7 7×MAX25W, DM-X8 8×MAX25W, DM-X9 9×MAX25W, DM-X10 10×MAX25W,  
DM-X12 12×MAX25W, DM-X15 15×MAX25W, DM-X16 16×MAX25W, DM-X17 17×MAX25W,  
DM-X18 18×MAX25W, DM-X19 19×MAX25W, DM-X20 20×MAX25W, DM-X21 21×MAX25W,  
DM-X22 22×MAX25W, DM-X23 23×MAX25W, DM-X24 24×MAX25W, DM-X27 27×MAX25W,  
DM-X28 28×MAX25W, DM-X30 30×MAX25W, DM-X32 32×MAX25W, DM-X35 35×MAX25W,  
DM-X40 40×MAX25W, DM-X42 42×MAX25W, DM-X46 46×MAX25W, DM-X50 50×MAX25W,  
DM-X52 52×MAX25W, DM-X55 55×MAX25W, DM-X57 57×MAX25W, DM-X60 60×MAX25W,  
DM-X62 62×MAX25W, DM-X65 65×MAX25W, DM-X67 67×MAX25W, DM-X70 70×MAX25W,  
DM-X75 75×MAX25W, DM-X80 80×MAX25W, DM-X85 85×MAX25W, DM-X90 90×MAX25W.

系列:

DM-D3 3×MAX25W, DM-D5 5×MAX25W, DM-D6 6×MAX25W, DM-D7 7×MAX25W,  
DM-D8 8×MAX25W, DM-D10 10×MAX25W, DM-D12 12×MAX25W, DM-D13 13×MAX25W,  
DM-D14 14×MAX25W, DM-D15 15×MAX25W, DM-D16 16×MAX25W, DM-D17 17×MAX25W,  
DM-D18 18×MAX25W, DM-D19 19×MAX25W, DM-D20 20×MAX25W, DM-D21 21×MAX25W,  
DM-D22 22×MAX25W, DM-D23 23×MAX25W, DM-D24 24×MAX25W, DM-D25 25×MAX25W,  
DM-D26 26×MAX25W, DM-D27 27×MAX25W, DM-D28 28×MAX25W, DM-D29 29×MAX25W,  
DM-D30 30×MAX25W, DM-D32 32×MAX25W, DM-D34 34×MAX25W, DM-D35 35×MAX25W,  
DM-D36 36×MAX25W, DM-D39 39×MAX25W, DM-D40 40×MAX25W, DM-D41 41×MAX25W,  
DM-D42 42×MAX25W, DM-D43 43×MAX25W, DM-D44 44×MAX25W, DM-D45 45×MAX25W,  
DM-D46 46×MAX25W, DM-D47 47×MAX25W, DM-D48 48×MAX25W, DM-D49 49×MAX25W,  
DM-D50 50×MAX25W, DM-D51 51×MAX25W, DM-D53 53×MAX25W, DM-D55 55×MAX25W,  
DM-D56 56×MAX25W, DM-D57 57×MAX25W, DM-D58 58×MAX25W, DM-D60 60×MAX25W,  
DM-D63 63×MAX25W, DM-D65 65×MAX25W, DM-D66 66×MAX25W, DM-D68 68×MAX25W,  
DM-D69 69×MAX25W, DM-D70 70×MAX25W, DM-D74 74×MAX25W, DM-D76 76×MAX25W.

注: 此附录与证书同时使用时效。



主任: 王克勤



中国质量认证中心

<http://www.cqc.com.cn>

中国·北京·西四环南路 185 号 100070

电话: +86 10 85985906



## 中国国家强制性产品认证证书

附 录

第 2 页 共 2 页

证书编号: 2018011001080139

纸 号: 1968239

DM-D78 78×MAX25W, DM-D80 80×MAX25W, DM-D82 82×MAX25W, DM-D84 84×MAX25W,  
DM-D86 86×MAX25W, DM-D88 88×MAX25W

220V~50Hz.

注: 此附录与证书同时使用时效。



主任: 王克勤



中国质量认证中心

<http://www.cqc.com.cn>

中国·北京·西四环南路 185 号 100070

电话: +86 10 85985906



## CERTIFICATE FOR CHINA COMPULSORY PRODUCT CERTIFICATION

CERTIFICATE NO.: 2018011001080139

NAME AND ADDRESS OF THE APPLICANT

Zhongshan GuZhen DieMei Lighting Electric Appliance Factory  
One Of The First Floor, Heshou Dongan North Road No. 213, Guzhen Town, Zhongshan City.

NAME AND ADDRESS OF THE MANUFACTURER

Zhongshan Xinhui Lighting Co., Ltd.  
No.019, 2nd Floor, Comprehensive Building, Huasia Lamp City, No.36, North Huanzhen Road,  
Henglan Town, Zhongshan City, Guangdong Province, P.R.China

NAME AND ADDRESS OF THE FACTORY

Zhongshan Xinhui Lighting Co., Ltd.  
No.019, 2nd Floor, Comprehensive Building, Huasia Lamp City, No.36, North Huanzhen Road,  
Henglan Town, Zhongshan City, Guangdong Province, P.R.China

PRODUCT NAME, MODEL AND SPECIFICATION

Fixed Luminaires (Ceiling Mounted/Suspended Mounted, Incandescent Lamp,  
Class I, IP20, Suitable For Direct Mounting On Normally Flammable Material,  
E14).

See Appendix, 220V~50Hz

THE STANDARDS AND TECHNICAL REQUIREMENTS FOR THE PRODUCTS

GB7000.1-2015;GB7000.201-2008

This is to certify that the above mentioned product(s) complies with the requirements of  
implementation rules for compulsory certification(REFNO-CNCA-C10-01:2014).

Valid from: Jun.04.2018

Valid until: Apr.07.2022

The validity of the certificate is subject to positive result of the regular follow up  
inspection by issuing certification body until the expiry date.

The certificate information is available through CNCA's website: [www.cnca.gov.cn](http://www.cnca.gov.cn)



President: 王克勤

Wang Kiqin



CHINA QUALITY CERTIFICATION CENTRE

<http://www.cqc.com.cn>

Section 7, No.185, Huanzhen Road, Beijing, 100070 P.R.China

tel: +86 10 85985906

Q 1968239



